

Ridge Line Bumper Instructions: Axial SCX10, Dingo, Honcho, 2013 Jeep Wrangler Rubicon

Note: For the SCX10 2012 Jeep Wrangler Rubicon Kits, you will need to replace the OEM AX80125 1 front frame bumper mount with the AX80046E 1 front frame bumper mount from the SCX10 Honcho kit. This will allow for proper mounting of the Ridge Line bumpers on the front of this vehicle.

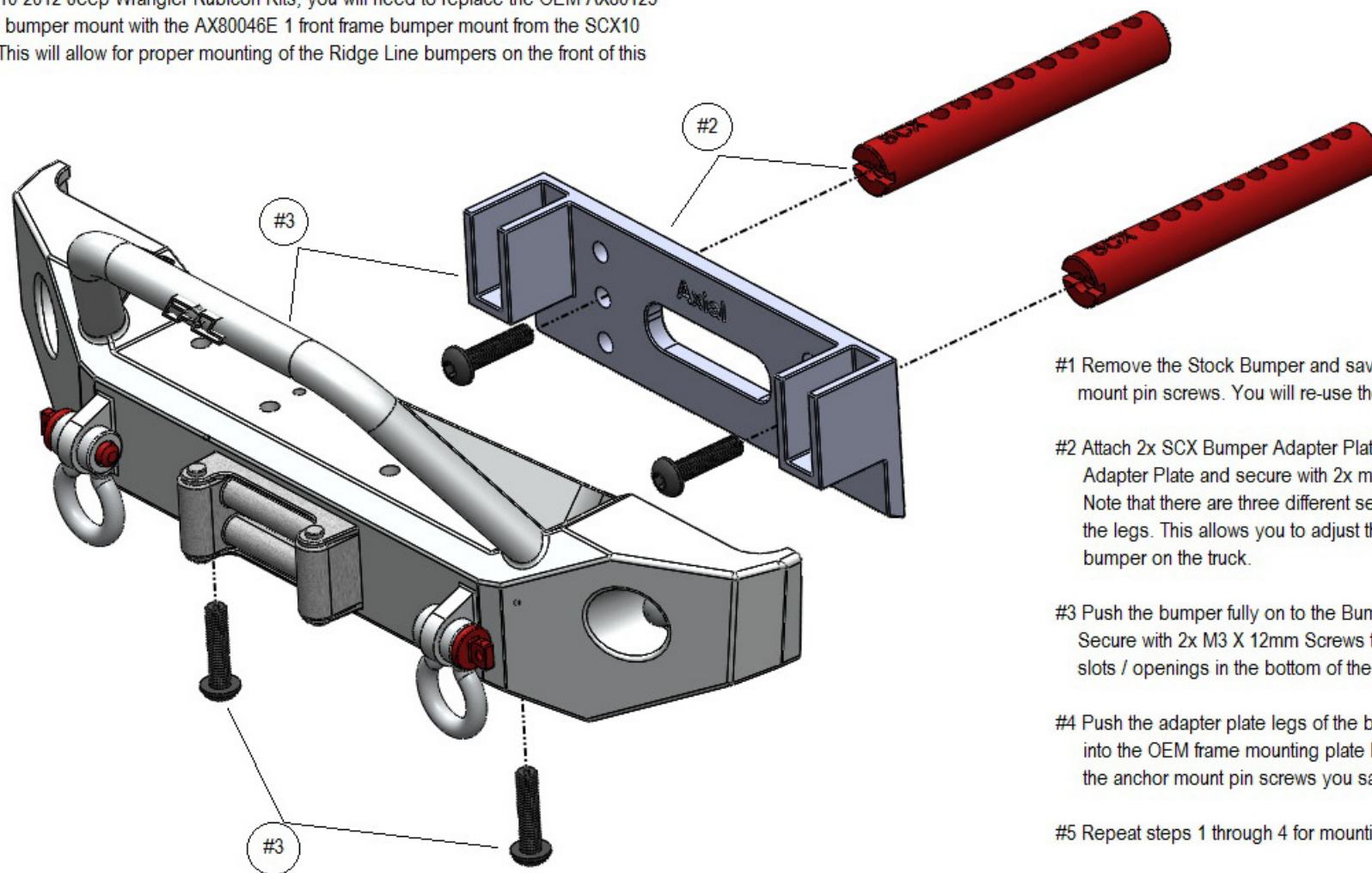

#1 Remove the Stock Bumper and save the existing anchor mount pin screws. You will re-use these later.

#2 Attach 2x SCX Bumper Adapter Plate Legs to the Axial Adapter Plate and secure with 2x m3 X 12mm Screws. Note that there are three different sets of mounting holes for the legs. This allows you to adjust the height position of the bumper on the truck.

#3 Push the bumper fully on to the Bumper Mounting Plate and Secure with 2x M3 X 12mm Screws through the 2x furthest slots / openings in the bottom of the bumper.

#4 Push the adapter plate legs of the bumper sub assembly into the OEM frame mounting plate bracket and secure with the anchor mount pin screws you saved from step #1

#5 Repeat steps 1 through 4 for mounting the rear bumper

PROLINE